

SPECIFICATIONS

FREQUENCY RANGE: DC TO 2.0 GHz
 IMPEDANCE: 50 OHMS
 ATTENUATION VALUES: 1 - 40dB IN ANY INCREMENT
 ACCURACY: ± 0.8 dB
 VSWR: 1.20:1
 INPUT POWER: 2 WATTS, 1,000 WATTS PEAK
 OPERATING TEMP: -55 TO +125 °C
 CONNECTORS: TYPE N MALE/MALE

REVISIONS				
REV	DESCRIPTION	DATE	BY	ECO

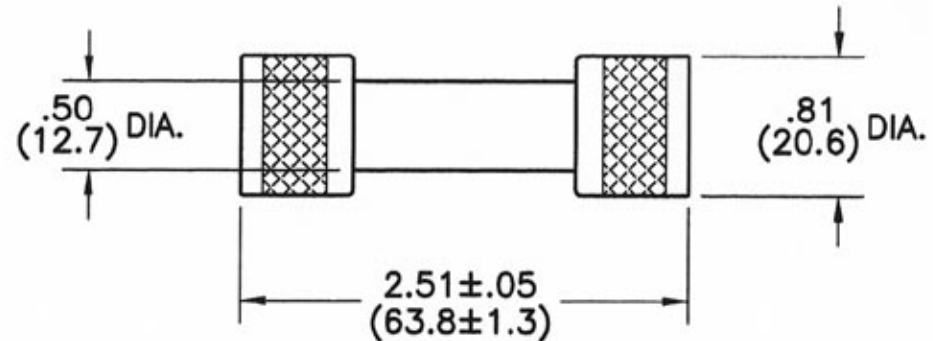

DIMENSIONS: INCHES
 (MILLIMETERS)

TOLERANCES	
DEC.XX ± .03	FRAC ±
.XXX ± .010	ANG ±
MATERIAL	
FINISH	

THE INFORMATION CONTAINED IN THIS DOCUMENT IS THE PROPERTY OF MICROWAVE DEVICES, INC. AND IS PROPRIETARY. IT IS NOT TO BE COPIED OR USED FOR ANY PURPOSE OTHER THAN AS INSTRUCTED, IN WRITING, BY MICROWAVE DEVICES, INC.		
SIGNATURES		DATE
DR	G.V.Cothron	12-30-07
CHK		
APPD		
APPD		

<small>RF and Microwave Components</small>		
OUTLINE DRAWING, MA-50A TYPE N M/M CONNECTORS		
CAGE	SIZE	DRAWING NO.
60674	A	900733-3
DRAWING SCALE 1:1		SHEET 1 OF 1

CONTACT: MICROWAVE DEVICES - 1150 N. GRAHAM RD.
 (317) 736-8833 FRANKLIN, IN 46131

DIMENSIONS ARE IN INCHES UNLESS OTHERWISE SPECIFIED.