

SPECIFICATIONS

FREQUENCY RANGE: 2.0 TO 8.0 GHz

INSERTION LOSS: 0.6 dB MAX

ISOLATION: 18 dB

VSWR: 1.40:1 - INPUT

1.30:1 - OUTPUT

POWER: 30 WATTS @ 1.2:1 LOAD VSWR

REVISIONS					
REV	ZONE	DESCRIPTION	DATE	BY	ECO
A	3D	1.87(47.4) DIM. WAS 1.55(39.4)	1-11-08	GVC	---
	---	CHANGED TO 4 HOLE MTO PATTERN			
	4A	REVISED PERFORMANCE SPECS.			
B	3A	1.75(44.5) DIM. WAS 1.87(47.4)	5-12-08	GVC	---
	4C	.48(12.1) DIM. WAS .54(13.8)			
	1C	.78(19.1) DIM WAS .89(17.5)			
	2C	.41(10.3) DIM WAS .34(8.7)			

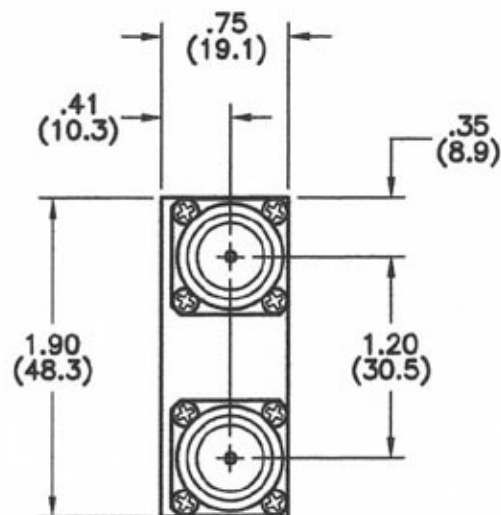
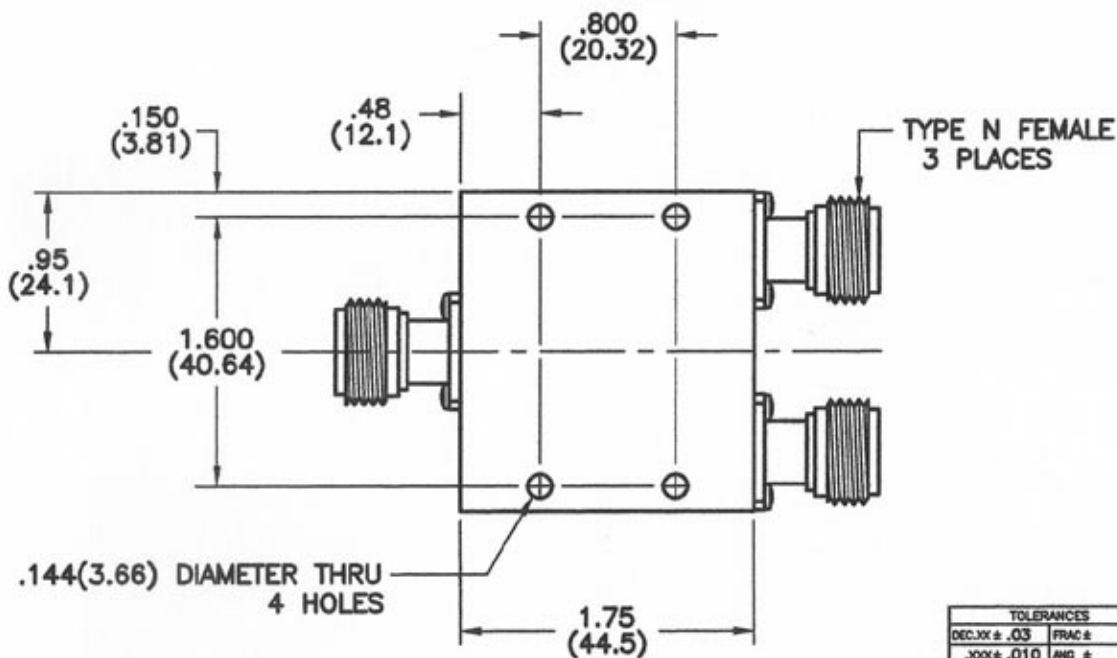

DIMENSIONS: INCHES
(MILLIMETERS)

TOLERANCES	
DEC.XX ± .03	FRACTION ±
.XXX ± .010	AND ±
MATERIAL	
FINISH	
CHK	
APPD	
APPD	

THE INFORMATION CONTAINED IN THIS DOCUMENT IS THE PROPERTY OF MICROWAVE DEVICES, INC. AND IS PROPRIETARY. IT IS NOT TO BE COPIED OR USED FOR ANY PURPOSE OTHER THAN AS INSTRUCTED IN WRITING, BY MICROWAVE DEVICES, INC.

SIGNATURES DATE
DR G.V.Cothren 3-2-08

Microwave Devices
RF and Microwave Components

OUTLINE, POWER DIMDER,
MODEL 2PD6.0N

CAGE SIZE DRAWING NO.
60674 B 900517

DRAWING SCALE 1.5:1 SHEET 1 OF 1

CONTACT: MICROWAVE DEVICES - 1150 N. GRAHAM RD. FRANKLIN, IN 46131 (317) 738-8633

DIMENSIONS ARE IN INCHES UNLESS OTHERWISE SPECIFIED.