

4

3

2

1

SPECIFICATIONS

FREQUENCY RANGE: 2.0 TO 8.0 GHz
 INSERTION LOSS: 0.3 dB TYPICAL
 0.6 dB MAX.

ISOLATION: 20 dB

VSWR: 1.35:1 - INPUT
 1.30:1 - OUTPUT

AMPLITUDE BALANCE: ± 0.4 dB MAX.

PHASE BALANCE: $\pm 5^\circ$ MAX.

POWER: 30 WATTS \odot 1.2:1 LOAD VSWR
 10 WATTS \odot 2.0:1 LOAD VSWR
 1 WATT \odot INFINITE LOAD VSWR

REVISIONS				
REV	ZONE	DESCRIPTION	DATE	BY ECO
A	4D	REVISED ELECTRICAL SPECIFICATIONS	5-12-03	GVC ---

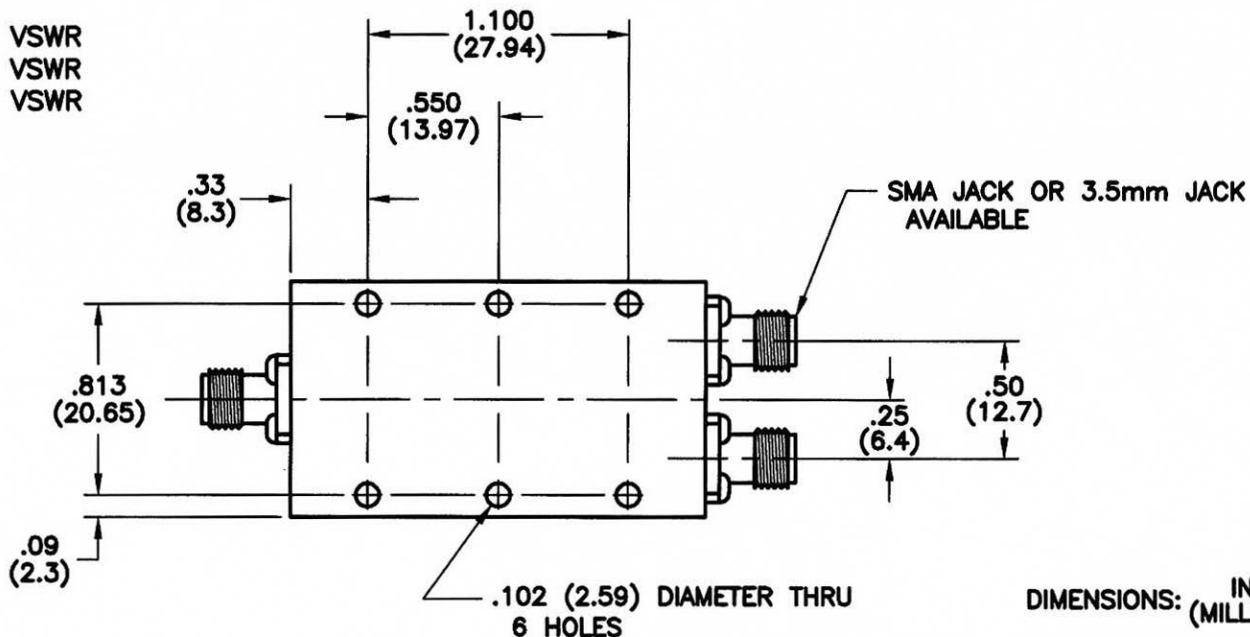
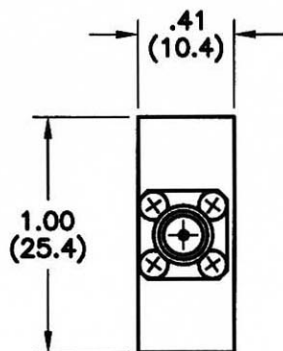
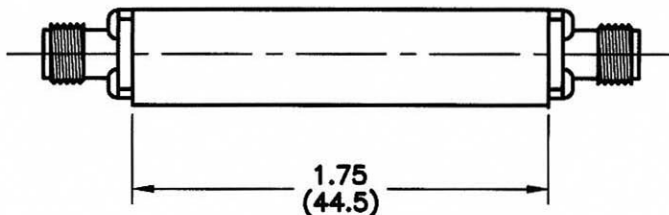

DIMENSIONS: INCHES
(MILLIMETERS)

TOLERANCES	
DEC.XX $\pm .03$	FRAC \pm
.XXX $\pm .010$	ANG \pm
MATERIAL	
FINISH	
SIGNATURES	
DR	G.V. Coltrane
CHK	
APPD	
APPD	
DATE	
	4-15-03

THE INFORMATION CONTAINED IN THIS DOCUMENT IS THE PROPERTY OF MICROWAVE DEVICES, INC. AND IS PROPRIETARY. IT IS NOT TO BE COPIED OR USED FOR ANY PURPOSE OTHER THAN AS INSTRUCTED, IN WRITING, BY MICROWAVE DEVICES, INC.

MICROWAVE DEVICES
 RF and Microwave Components

OUTLINE, POWER DIVIDER,
 MODEL 2PD6.0

CAGE SIZE DRAWING NO.
 60674 B 900369

CONTACT: MICROWAVE DEVICES - 388 STATE STREET
 (317) 736-8833 FRANKLIN, IN 46131

DIMENSIONS ARE IN INCHES UNLESS OTHERWISE SPECIFIED.

DRAWING SCALE 2=1 SHEET 1 OF 1

4

3

2

1